

Smart Lock Installation Guide v1.0.0

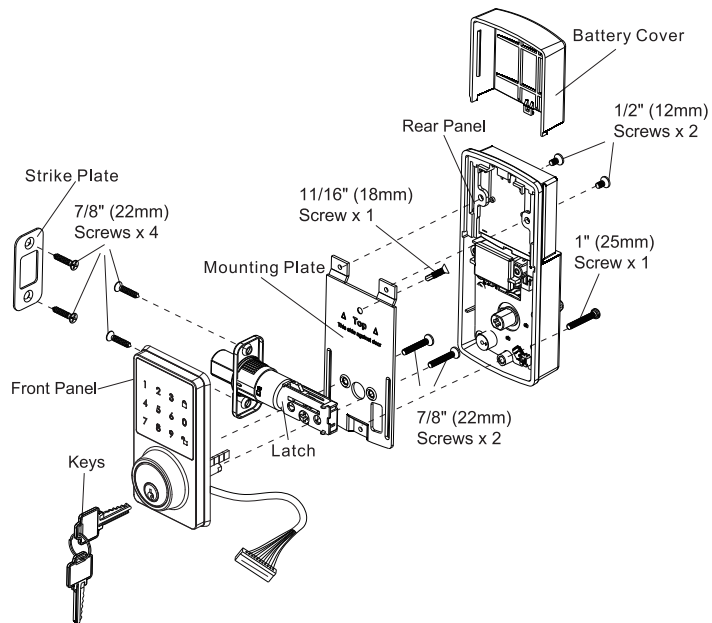



①

FOLD HERE ON
DOOR EDGE

②

MARK
FOR
 $1\frac{3}{4}$ " (45mm)
DOOR

MARK
FOR
 $1\frac{3}{8}$ " (35mm)
DOOR

③

THEN DRILL 1" (25mm) HOLE
IN CENTER OF DOOR EDGE
(2" IN DEPTH)

TEMPLATE

FOR INSTALLING
ENTRY LOCK AND DEADBOLTS

$2\frac{3}{8}$ " (60mm) BACKSET

$2\frac{3}{4}$ " (70mm) BACKSET

IMPORTANT!
PLACE TEMPLATE
ON HIGH EDGE OF
DOOR BEVEL

④

MARK CENTER
OF HOLE ON
DOOR FACE

⑤

DRILL
 $2\frac{1}{8}$ " (54mm)
HOLE

Component List

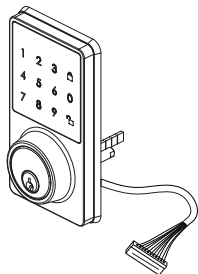

Front Panel

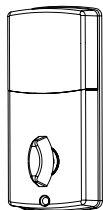

Rear Panel

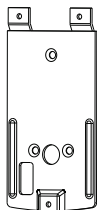

Mounting Plate

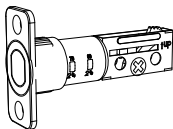

Deadbolt Latch (Adjustable)
2-3/8" (60mm) to 2-3/4" (70mm)



Strike Plate

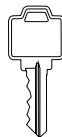

Keys



1/2" (12mm) Screws

x 2

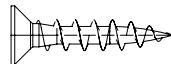

7/8" (22mm) Screws

x 4

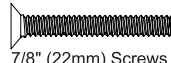

7/8" (22mm) Screws

x 2

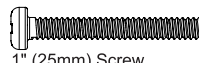

1" (25mm) Screw

x 1



11/16" (18mm) Screw

x 1

Tools Needed



Standard
Phillips Head
Screwdriver



Utility Knife



Drill



1" (25mm) Drill Bit



Tape Measure



Pencil



2-1/8" (54mm)
Hole Saw



Chisel

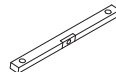

Level

Tools necessary only for new doors or adjusting existing prep.

Before you begin, open door and remove your existing deadbolt.

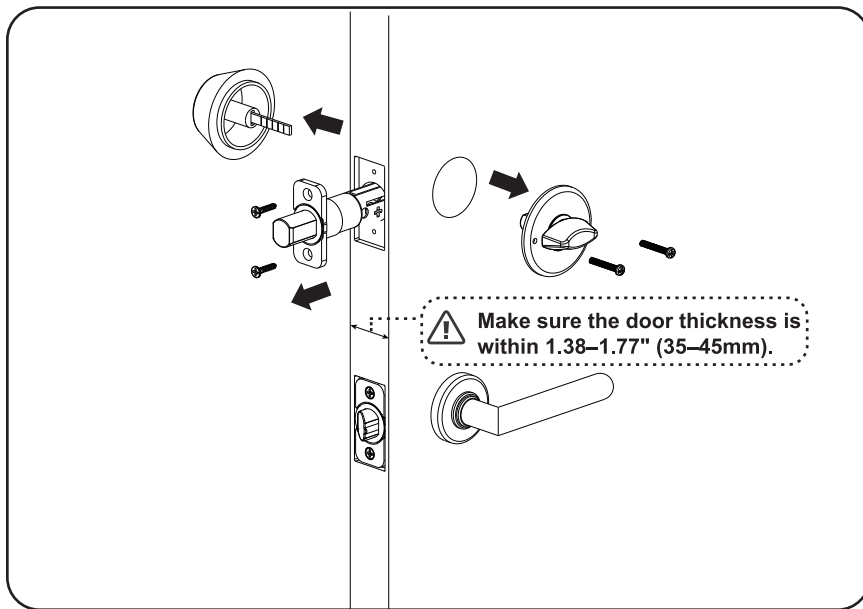

Before you begin, double check your door prep measurements.

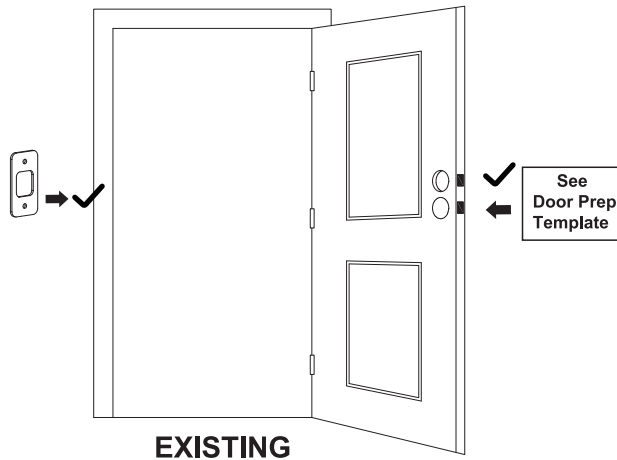
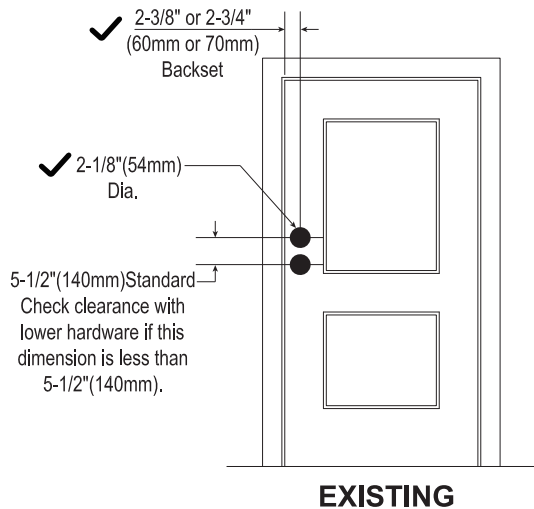

1 Drilling Holes (for New Doors or Adjusting Existing Prep.)

See
Door Prep
Template

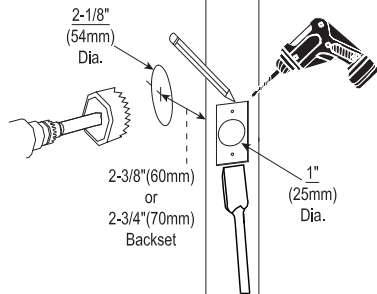

Make sure the latch plate is flush with door edge.

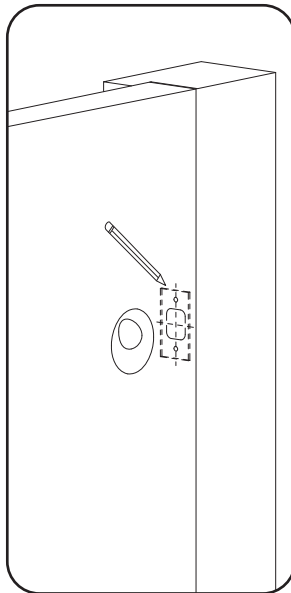

Make sure the strike plate is flush with door edge.

2

Installing the Deadbolt Latch

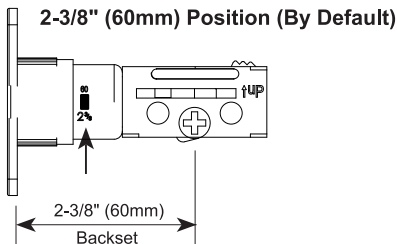

OR

2-3/4" (70mm) Position

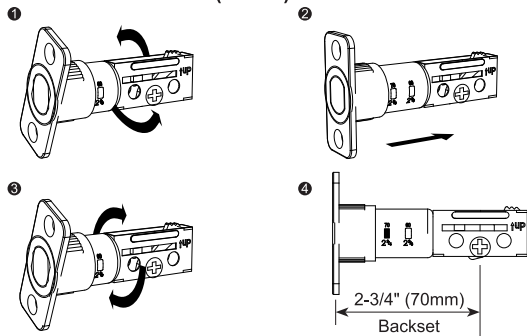

- Deadbolt latch must be in retracted (unlocked) position.
- Note UP arrow on the latch.
- Make the latch plate flush with the door edge.

7/8" (22mm) Screws

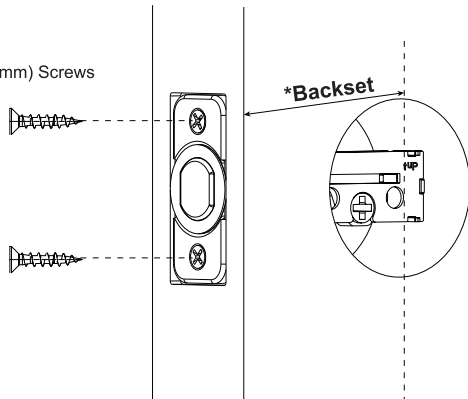

*2-3/8" (60mm) or 2-3/4" (70mm)



Installing the Strike Plate

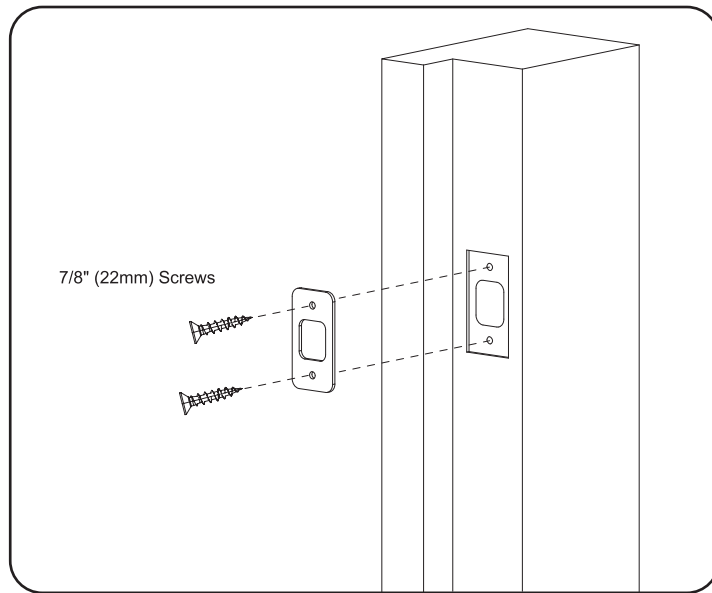

4

Installing the Front Panel



- Deadbolt latch must be in retracted (unlocked) position.
- Make sure the silicone pad is properly attached to the front panel.
- Make the tailpiece vertically inserted into the cross shaped hole.

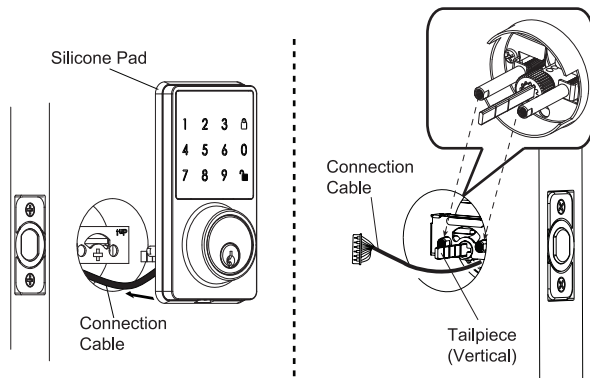

Outside of Door

Inside of Door

5

Testing Operation



- Rotate the key to check whether the latch can stretch out or retract freely and easily. If not:
- ① Check whether the tailpiece is vertical;
 - ② Reinstall the front panel according to step 4 if the tailpiece is already vertical.

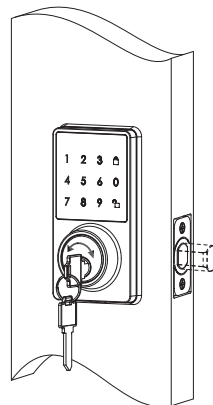

6

Installing the Mounting Plate



- Pay attention to the mark on one side of the plate.
- Make sure the mounting plate and front panel are level before tightening screws.

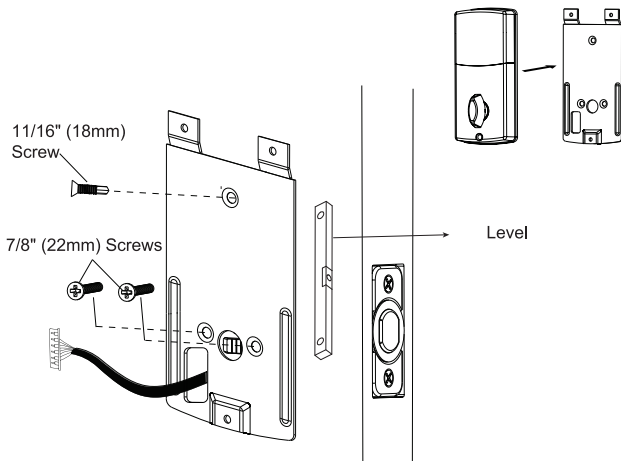

7

Attaching the Connection Cable



Connect the cable with pin side up (i.e. the smooth side down).

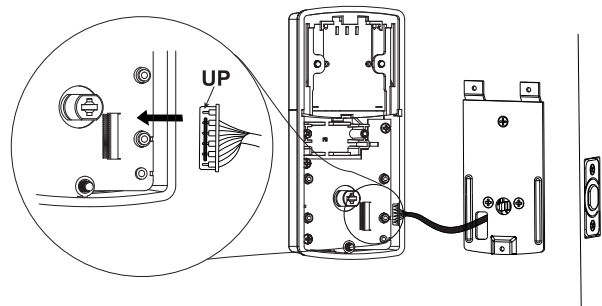



Confirming the Thumbturn Position



- Before installing the rear panel, check your lock installation place on the door (picture 1 or picture 2), and rotate the thumbturn to the position as indicated by the corresponding pictures; otherwise, the installation might fail.
- Deadbolt latch must be in retracted (unlocked) position.

①

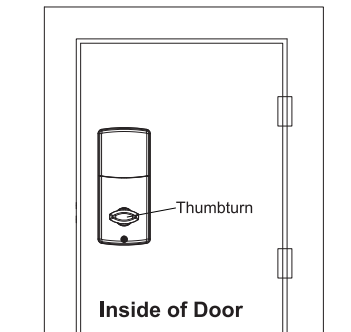

OR

②

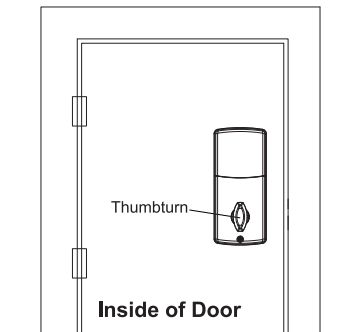

9

Installing the Rear Panel



- Deadbolt latch must be in retracted (unlocked) position.
- Insert the tailpiece into the cross hole on the rear panel.
- Make sure the rear panel is properly attached to the mounting plate.

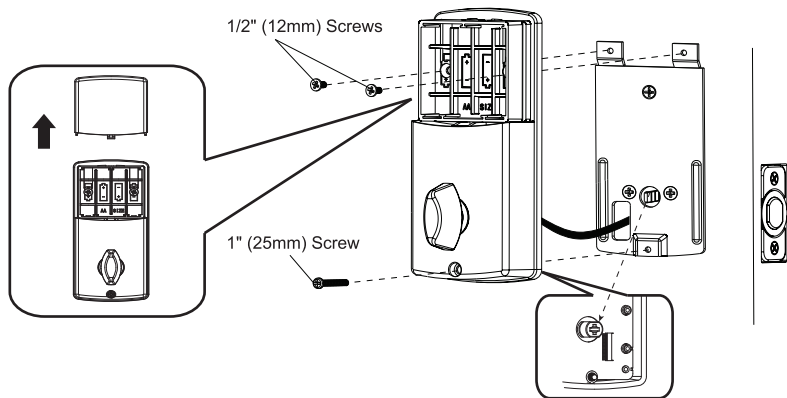

10

Testing the Lock



Rotate the thumbturn to check whether the latch can stretch out or retract freely and easily. If not:

- ① Check whether the tailpiece is vertical;
- ② Make sure the initial status of the thumbturn is rotated to the position as indicated by the pictures below.
- ③ Reinstall the rear panel according to step 9 if ① and ② are confirmed.

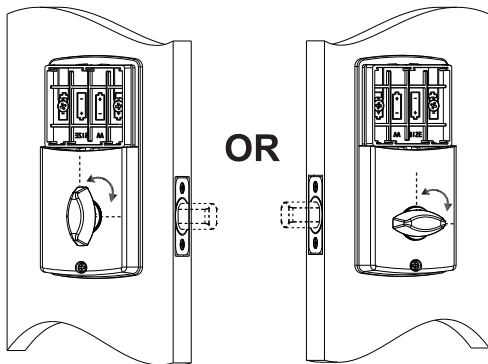

11

Installing Batteries



Make sure the battery polarity is correctly aligned inside the lock; otherwise, the lock cannot start.

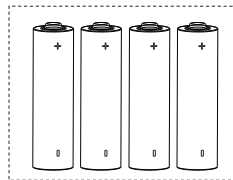

4 AA 1.5V
alkaline batteries

Buzzer beeps, and the keypad illuminates.

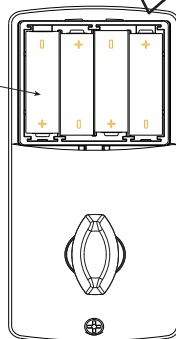

12

Testing the Keypad



Before installing the battery cover, ensure the lock is functioning normally.

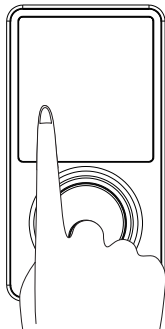

Touch the screen to activate the lock.

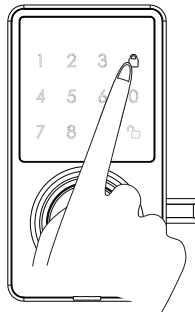

Touch 



- The door is **locked** (bolt stretches out), go to **step 14**.
- The door is **unlocked** (bolt still retracts), refer to **step 13**.

13

Changing the Lock Installation Direction



The following programming is needed if:

- ❶ The installation is completed, but the door is unlocked after tapping , and it is locked after entering the user code and tapping .
- ❷ The lock installation direction is changed on the door (from left to right, or from right to left).



The operations on the right are effective only when the lock is in initial status (under factory settings). If not, restore the lock to default. For detailed programming, see "**03 settings > 8: Restoring to Factory Settings**" in the user's manual.

Remove the batteries and wait 10 seconds. Insert the batteries back into the device, one short beep and one long beep will sound and the keypad will illuminate.

One long and one short beeb.
The keypad illuminates.

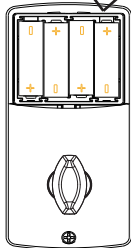

Within 3 seconds, enter the unlocking code (1234 or 123456), and then tap . Buzzer beeps, and the door is locked (bolt stretches out).

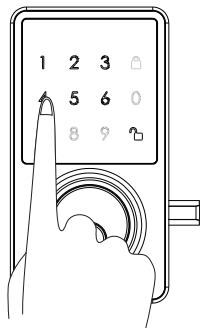



Installing the Battery Cover

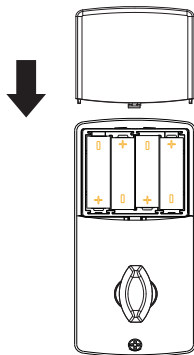

**Slide the battery cover back onto the lock.
You have not finished installing your lock.
Please read the user's manual carefully for
programming instructions.**